

CERTIFIED RECORD OF LAND CORNER MONUMENTATION

History of original corner establishment: \*

The original corner was established in 1880 by Bamford Robb under Contract No. 366 dated August 18, 1880. The original notes state:

DIAGRAM  
T17S R29E  
S19  
1/4---  
S30

Set stone 16x12x4 in mound of stone for 1/4 sec cor from which A pine 6 in dia bears N 62° W 42 lks dist.

Description of corner evidence found:

Found a 19x18x2" (16x14x4") stone in a mound of stone, possible "+" or 4 visible on the upper face. The stump of an 18" windfall P.Pine bears N61-3/4°W, 27.6 ft (N62°W, 42 lks), S (backwards S) visible on down side.

Description of monument and accessories I establish to perpetuate the original location of this corner:

Set a 2 1/2 x 28" aluminum monument 22" in the ground in a mound of stone and buried the original stone on the west side.

T17S R29E  
S19  
1/4---  
S30  
PLS1918  
1988

I establish new bearing trees:

A 5" P.Pine bears N46-3/4°E, 5.1 ft, scribed 1/4S19BT.

A 7" P.Pine bears S56 1/4°E, 12.1 ft, scribed 1/4S30BT.

New BTs have 3/4" brass washers marked PLS1918 attached to the BT blaze, faces and bands painted with red tree marking paint, and BT tags and Attention or Land Survey Monument signs. A steel fence post with Attention or Land Survey Monument sign is driven approximately 3-5 feet from the corner.

Smokey Cadastral Survey, Cont. No. 53-04H1-7-4011

Field Book: FB 3-46

Work accomplished: 6/22/88

Witnesses: Tyler Parsons  
              Louise Parsons  
              Sharon Parsons

Job No.: 87226

PARSONS SURVEYING  
1915 S.E. Stone Street  
Corvallis, OR 97333  
(503) 752-7515

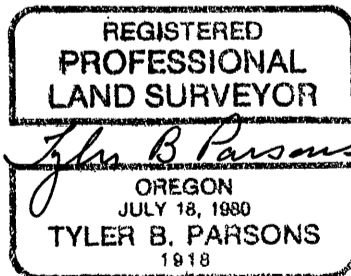

Office of COUNTY SURVEYOR County of GRANT  
State of OREGON, I hereby certify that the within instrument was filed in this office  
for record on the 4 day of Nov, 19 88

Robert D. Baggett by \_\_\_\_\_  
(COUNTY OFFICIAL) (DEPUTY)